

OVERALL SOUTH VIEW — CURRENT STATE



OVERALL SOUTH VIEW — BPD PRAGOPROJEKT (2006)



OVERALL SOUTH VIEW — TRANSPORT-ARCHITECTURAL STUDY (2020)



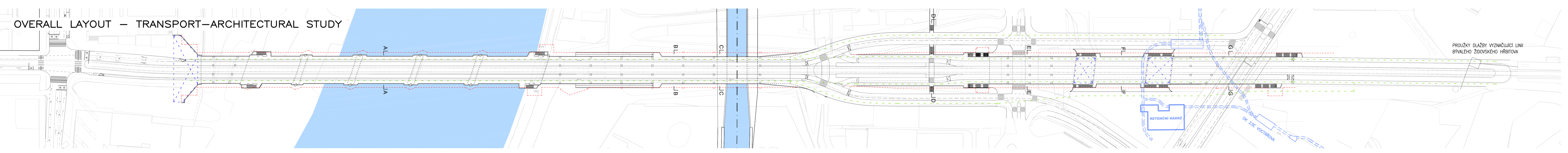
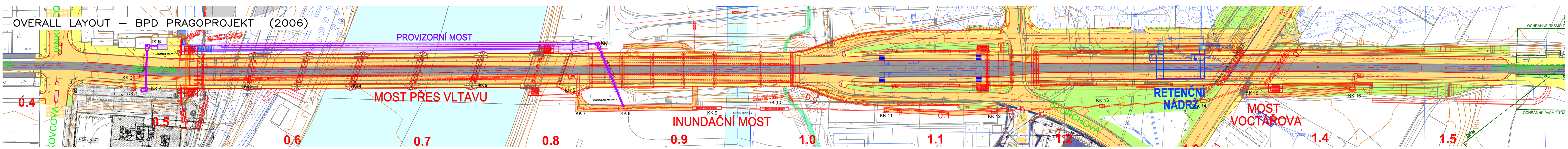
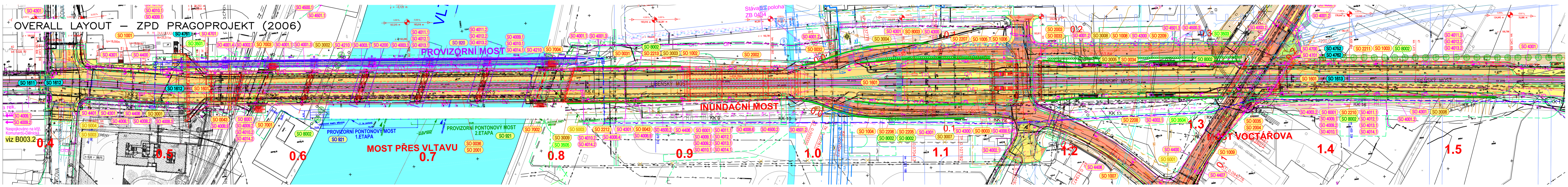

KEY	FRAME CONST.	HISTORIC ARCH BRIDGE OVER VLTAVA V009	NEW INUNDATION (FLOOD) BRIDGE	EMBANKMENT BODY ROAD	BRIDGING ŠTORCHOVA	ARCH BRIDGE X656	BRIDGING VOCTÁŘOVA	TERRAIN SECTION
<ul style="list-style-type: none"> Construction borders, BPD PRAGOPROJEKT Engineering networks - TRANSPORT-ARCHITECTURAL STUDY Commercial space under the bridge New retention tank, D-PLUS 	<ul style="list-style-type: none"> New frame construction 	<ul style="list-style-type: none"> Reconstructed arch bridge V009 over Vltava (width 21 m). Engineering networks inside bridge construction 		<ul style="list-style-type: none"> New embankment body road, tram stop New ramp placement Width profile at the tram stop=24 m 	<ul style="list-style-type: none"> New frame construction 	<ul style="list-style-type: none"> Existing bridge reconstruction Landscaping under the arch Commercial space under the bridge 	<ul style="list-style-type: none"> New frame construction Retention tank situated outside the construction 	<ul style="list-style-type: none"> Within the paved areas, strips of stone paving will symbolically indicate the original historical outline of the former Jewish cemetery (in accordance with geotect position indicated by historical documentation)

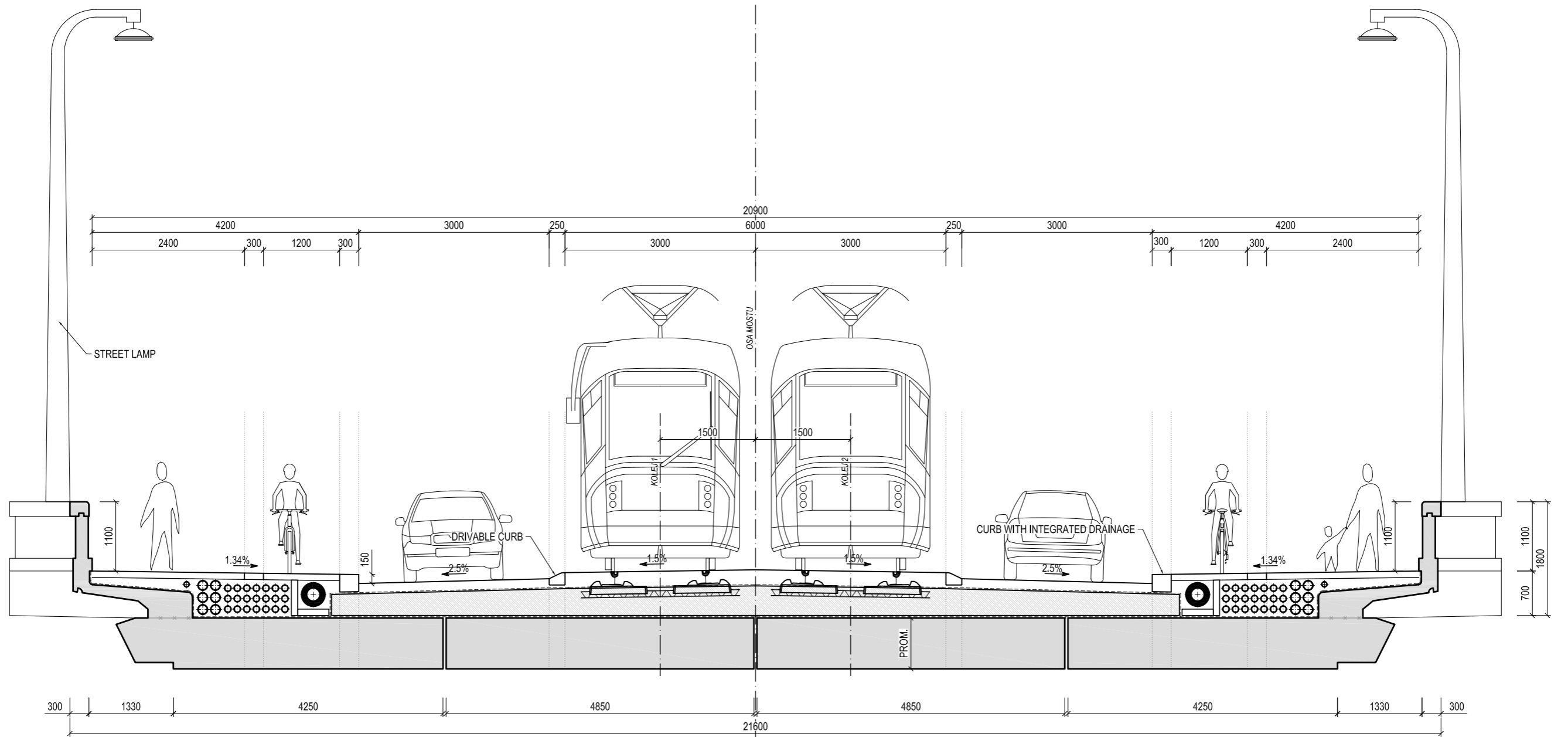

CROSS SECTION AA

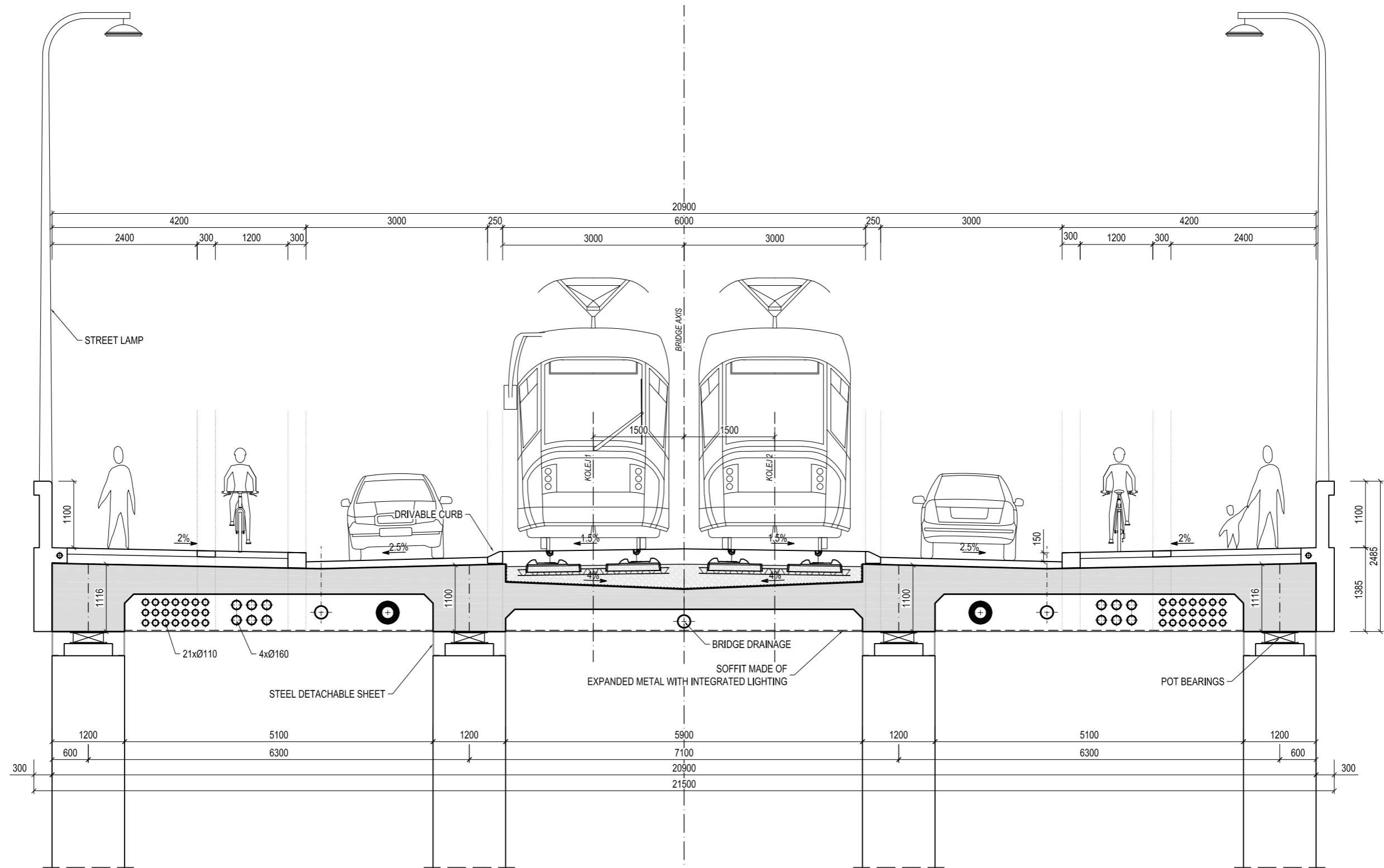

CROSS SECTION BB

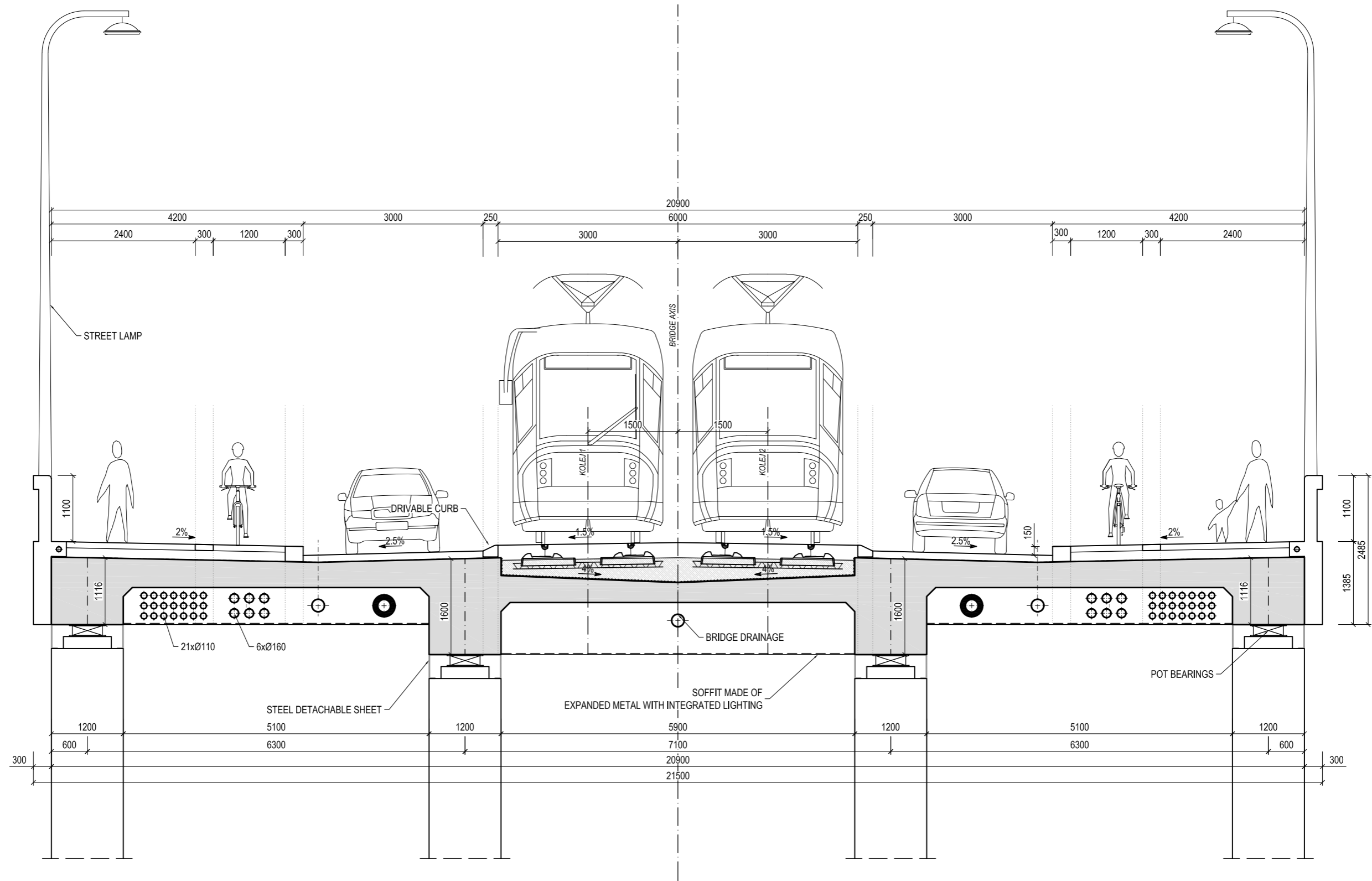

CROSS SECTION CC

south exit / outbound ramp

tram stop

north access / inbound ramp

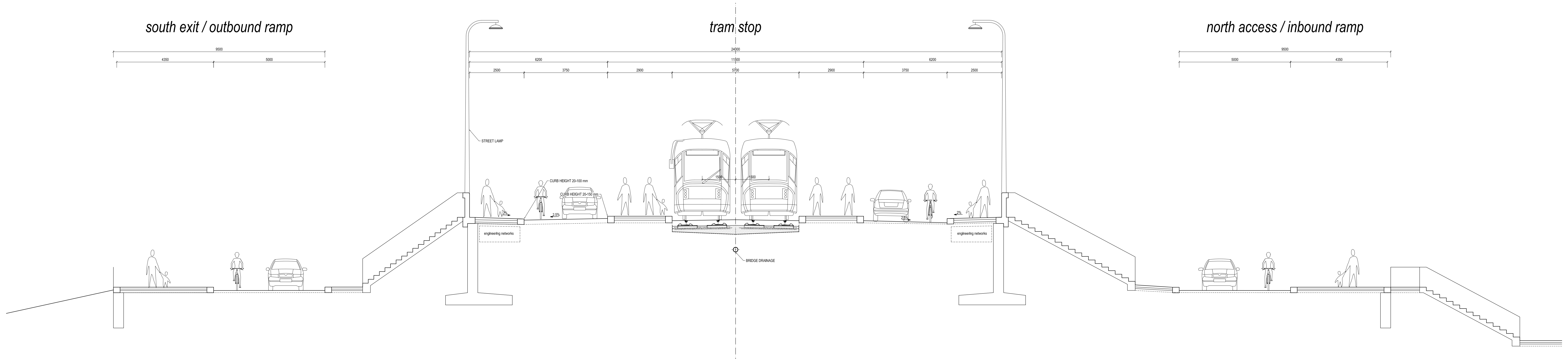

CROSS SECTION DD

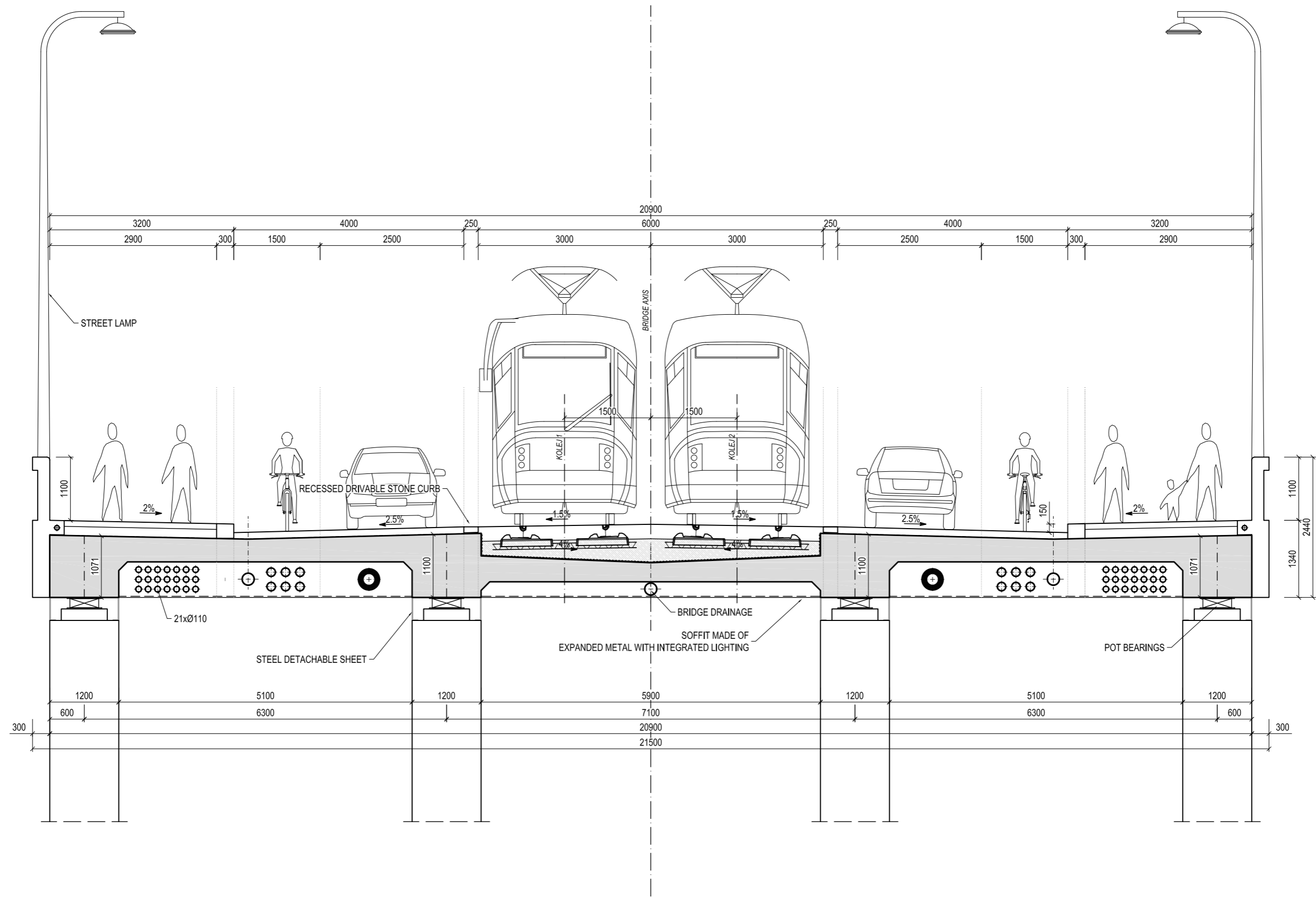

CROSS SECTION EE

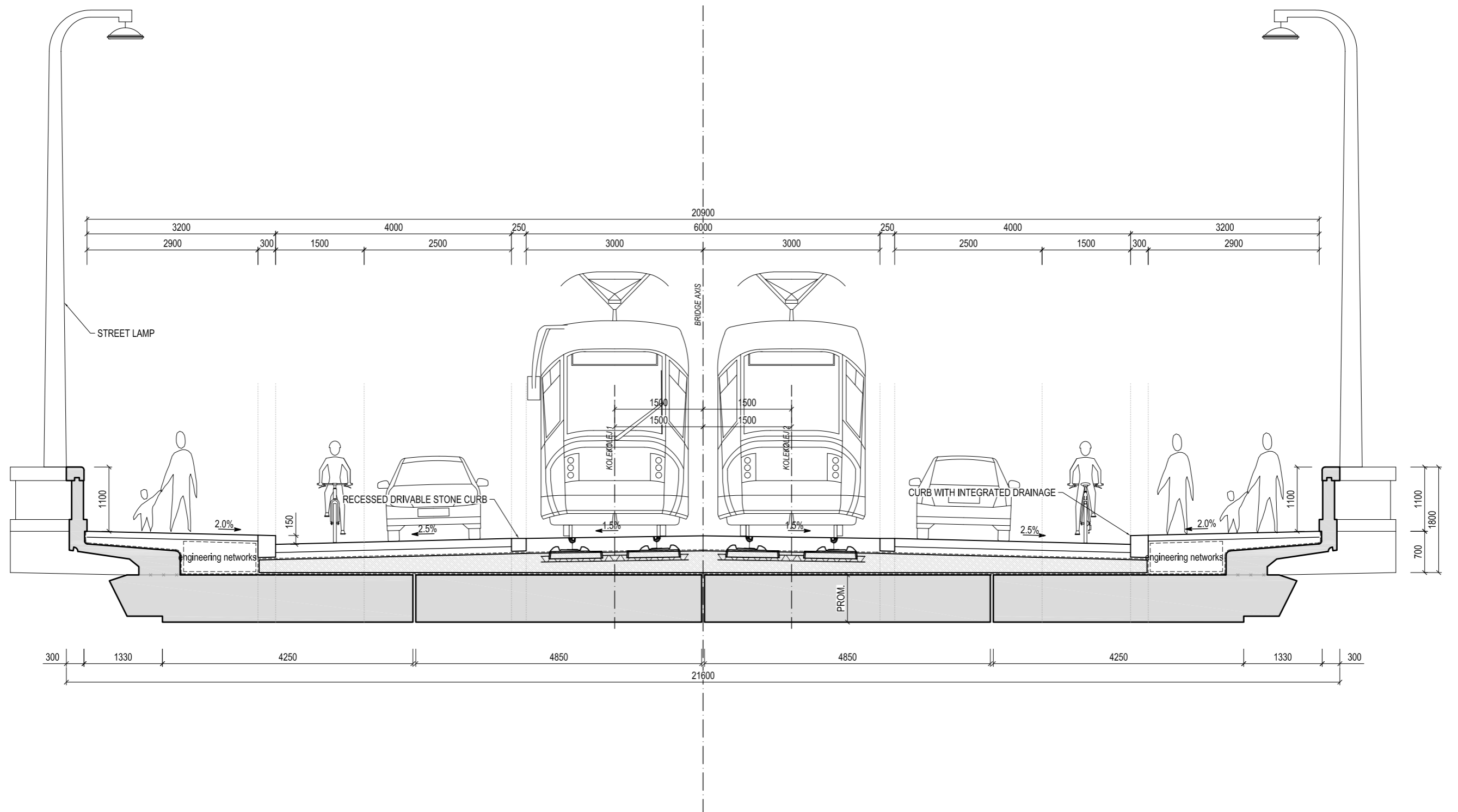

CROSS SECTION FF

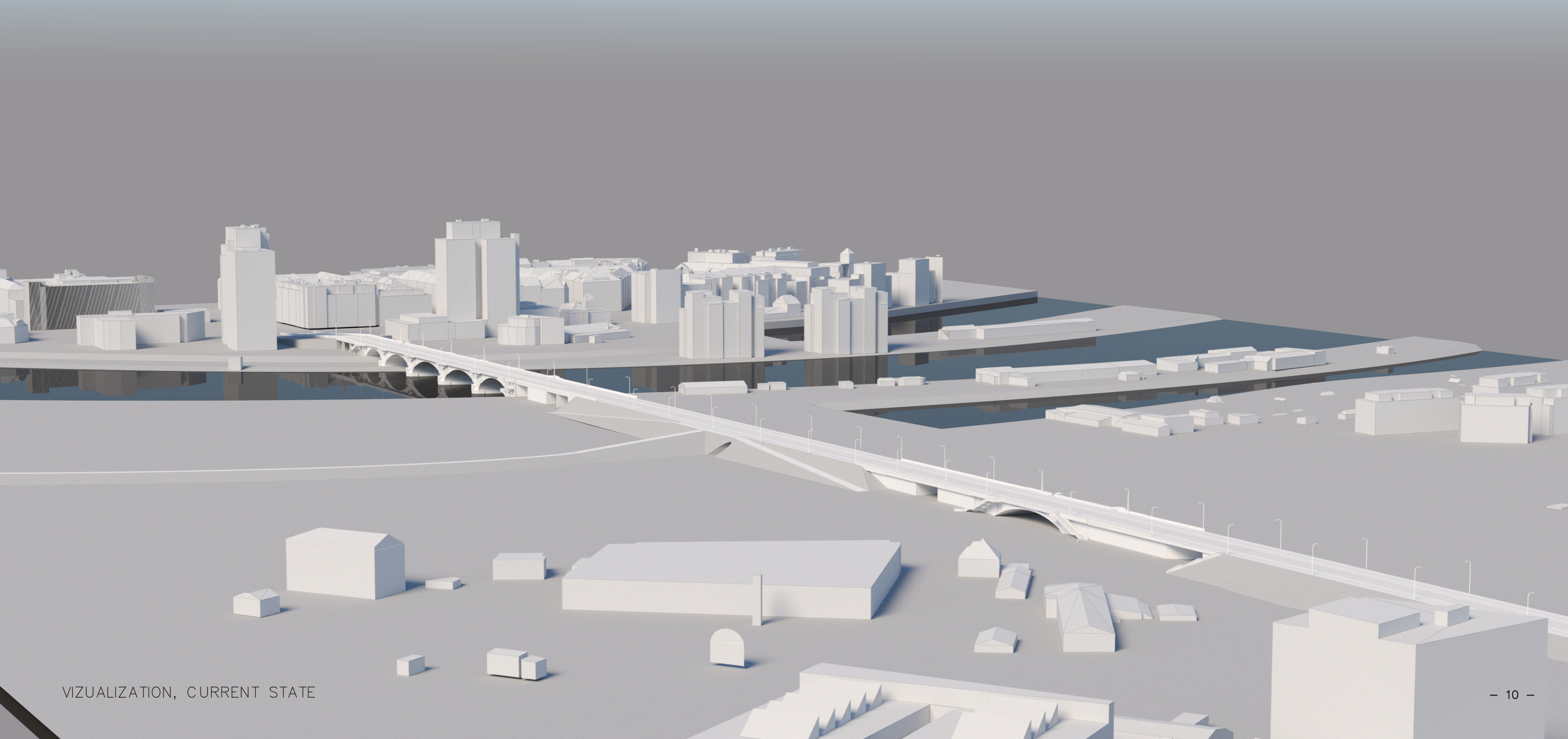

VIZUALIZATION, CURRENT STATE

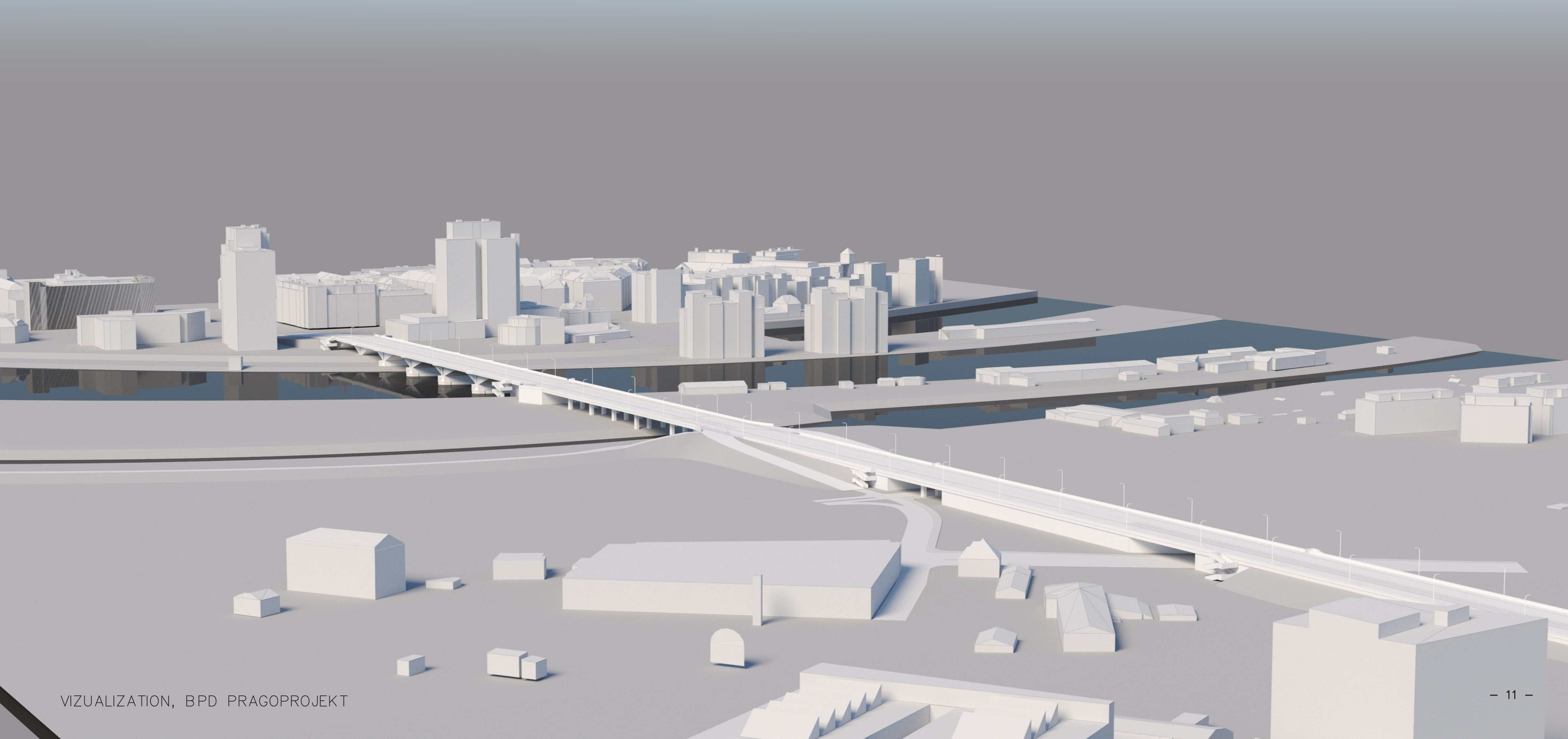

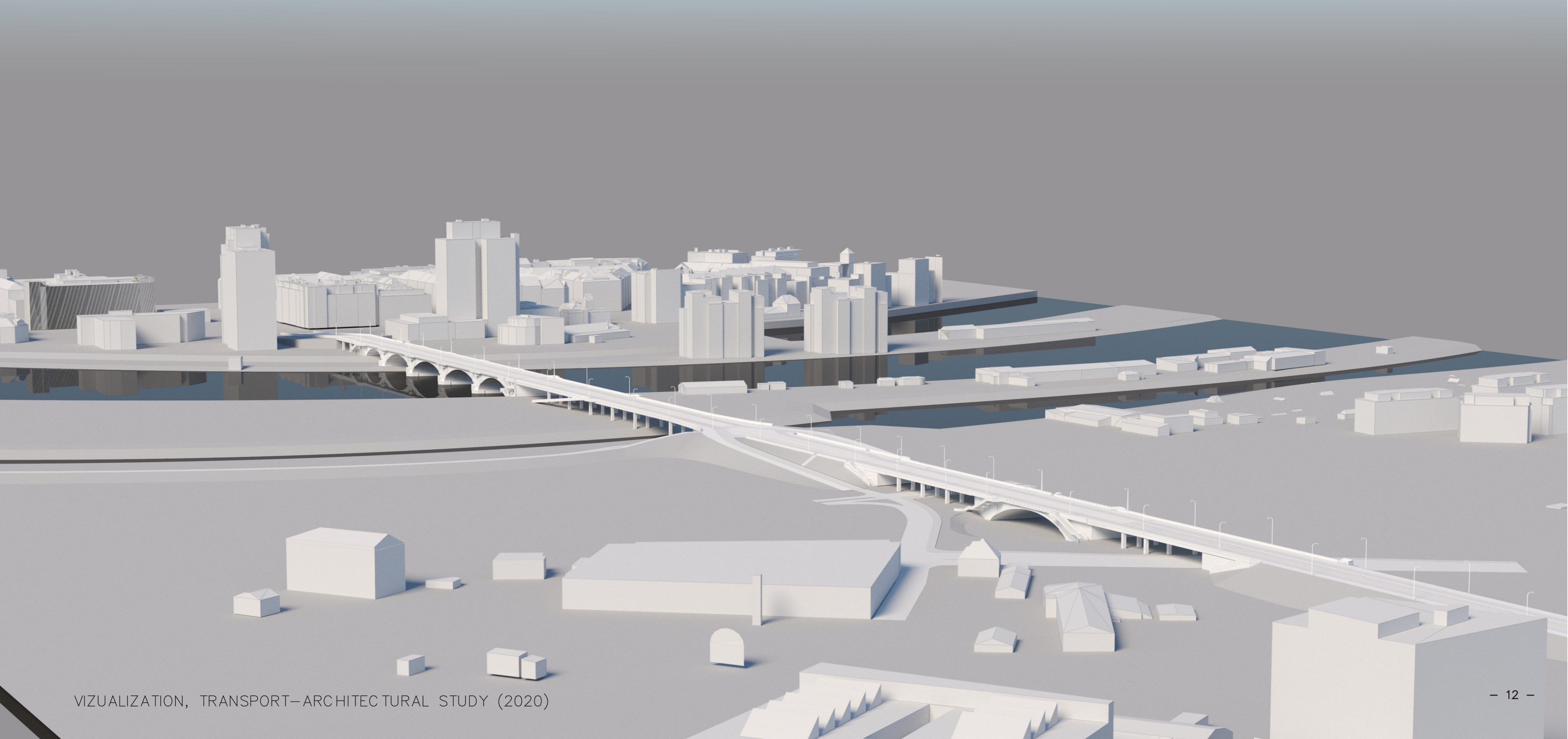

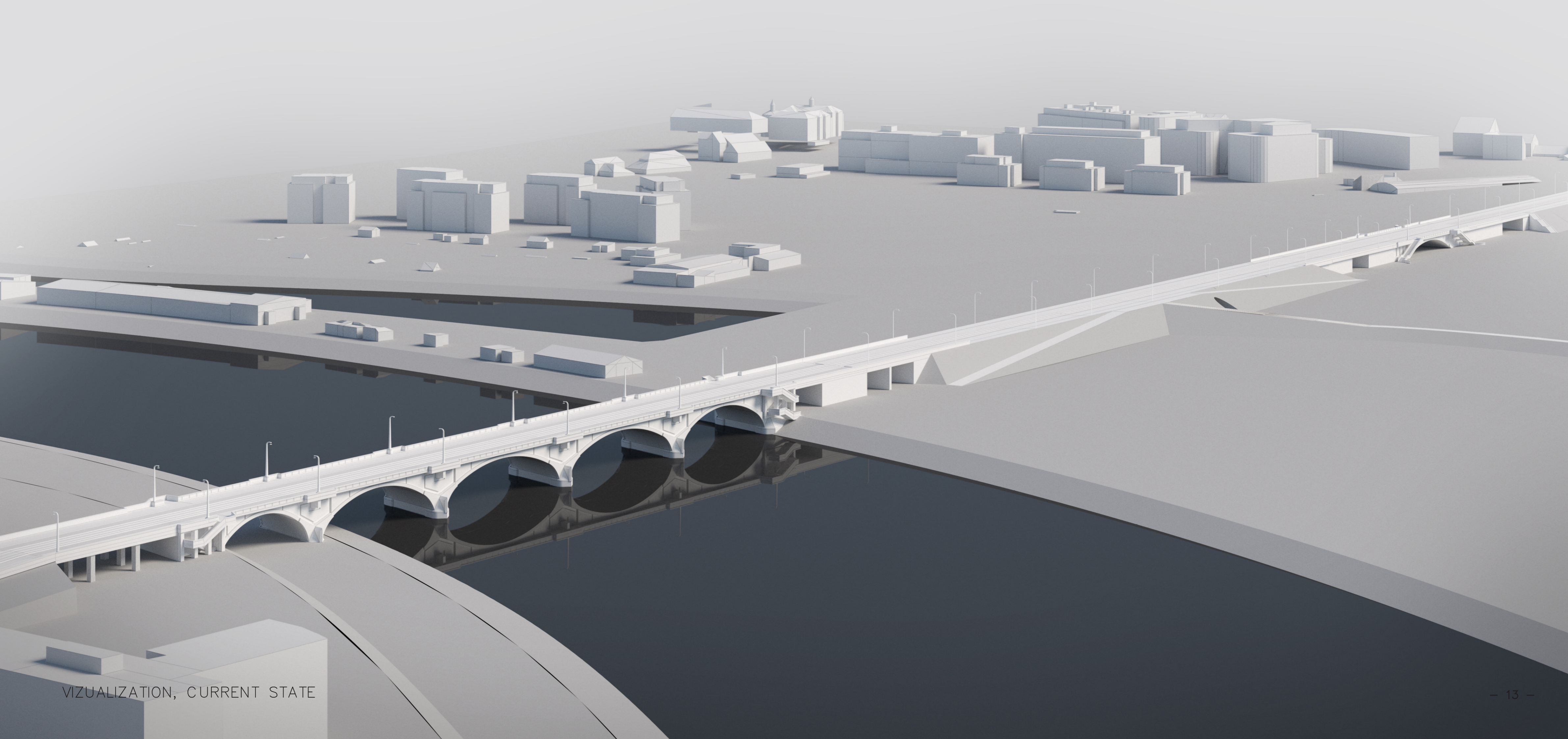

VIZUALIZATION, CURRENT STATE

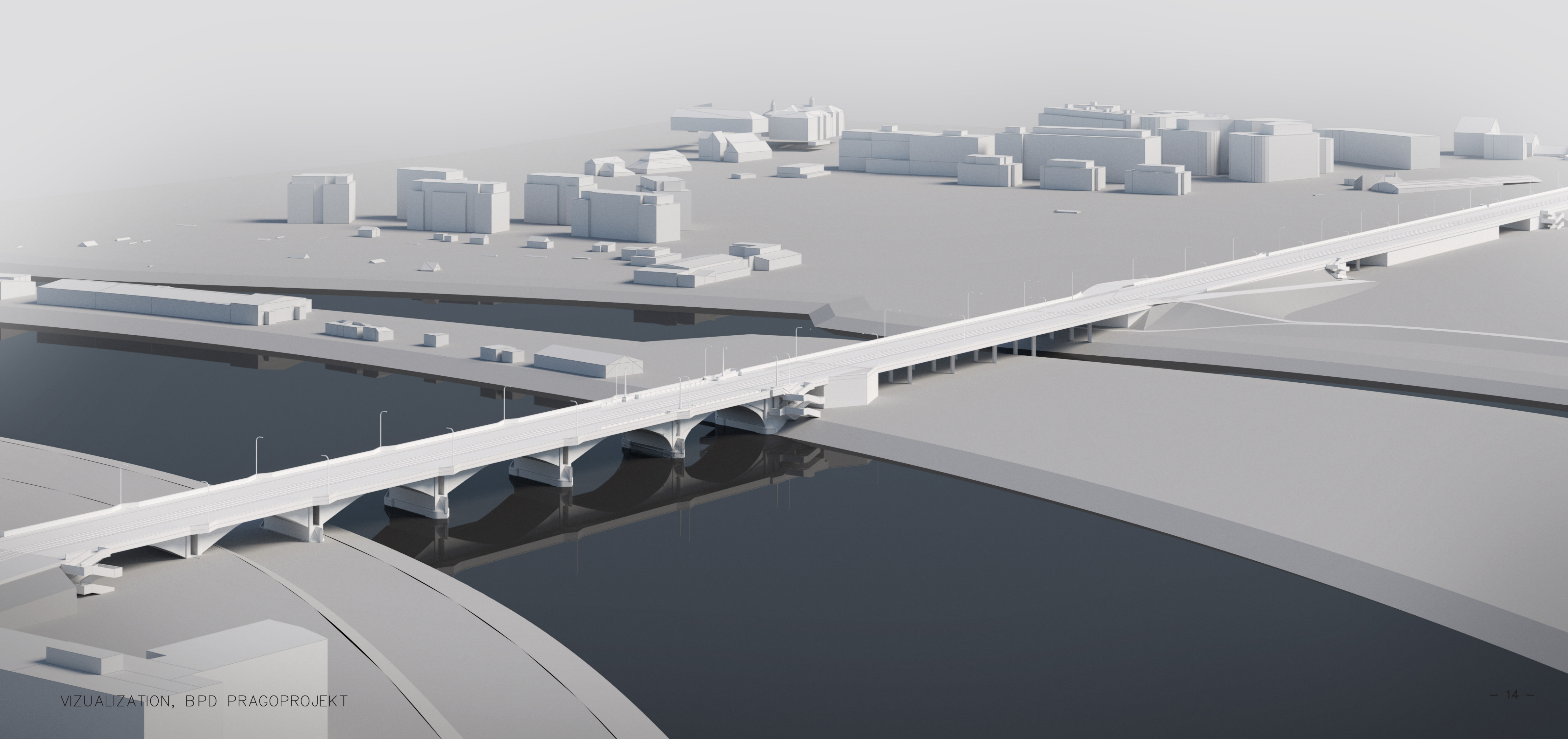

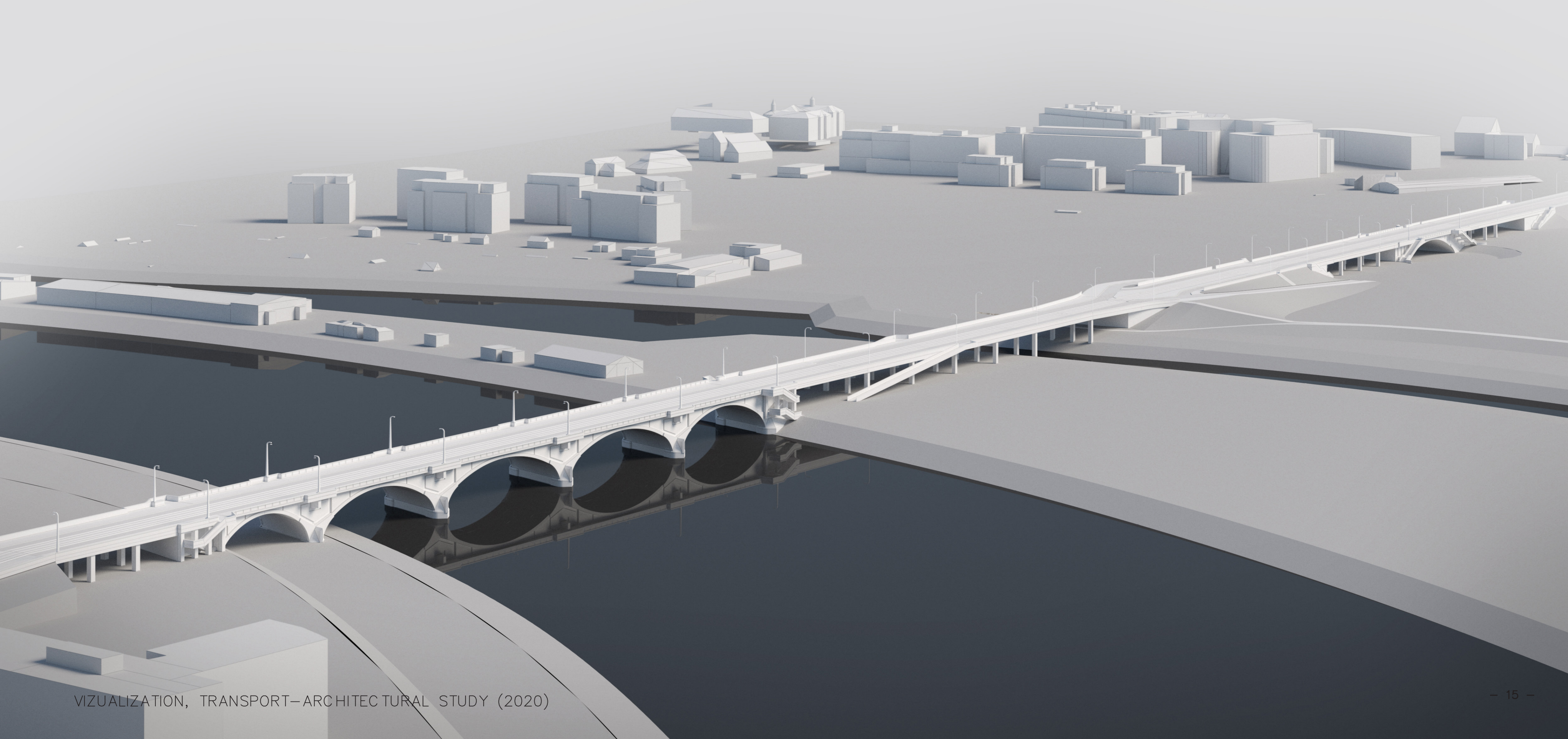





OVERLAY: TRANSPORT-ARCHITECTURAL STUDY (2020) + CURRENT STATE (2020) + ROHAN CITY + BPD PRAGOPROJEKT (2006)

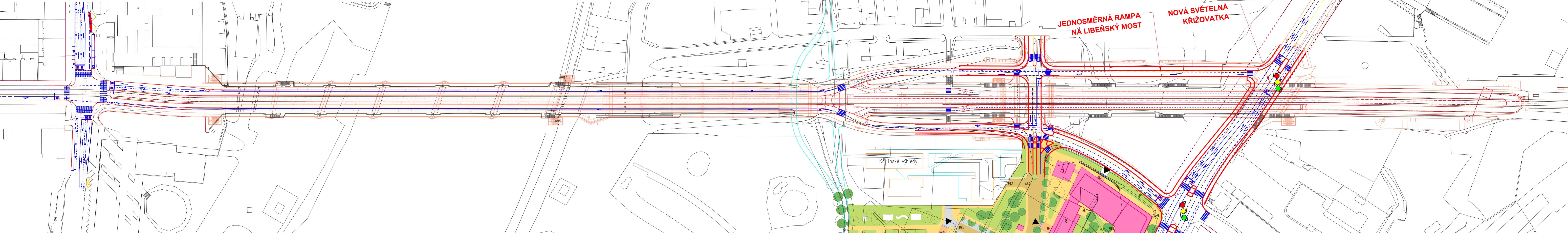

OVERLAY: TRANSPORT-ARCHITECTURAL STUDY (2020) + BPD PRAGOPROJEKT (2006)

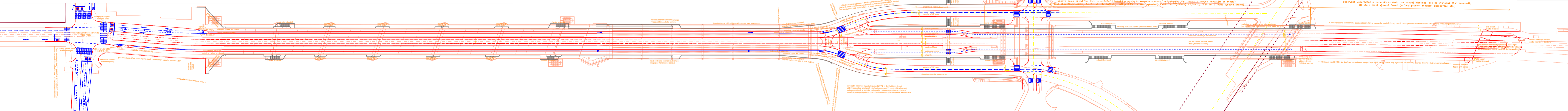

+ popis

OVERLAY: TRANSPORT-ARCHITECTURAL STUDY (2020) + CURRENT STATE (2020)

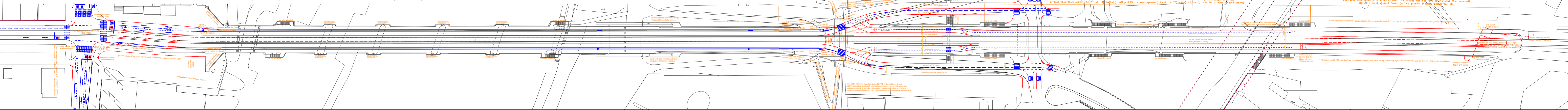

+ popis

TRANSPORT-ARCHITECTURAL STUDY (2020)

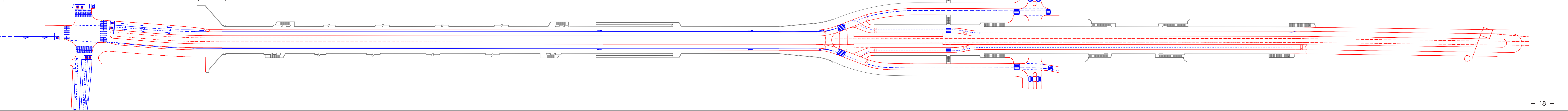

OVERLAY: T-A STUDY (2020) + CURRENT STATE + ROHAN CITY + BPD PRAGOPROJEKT (2006)

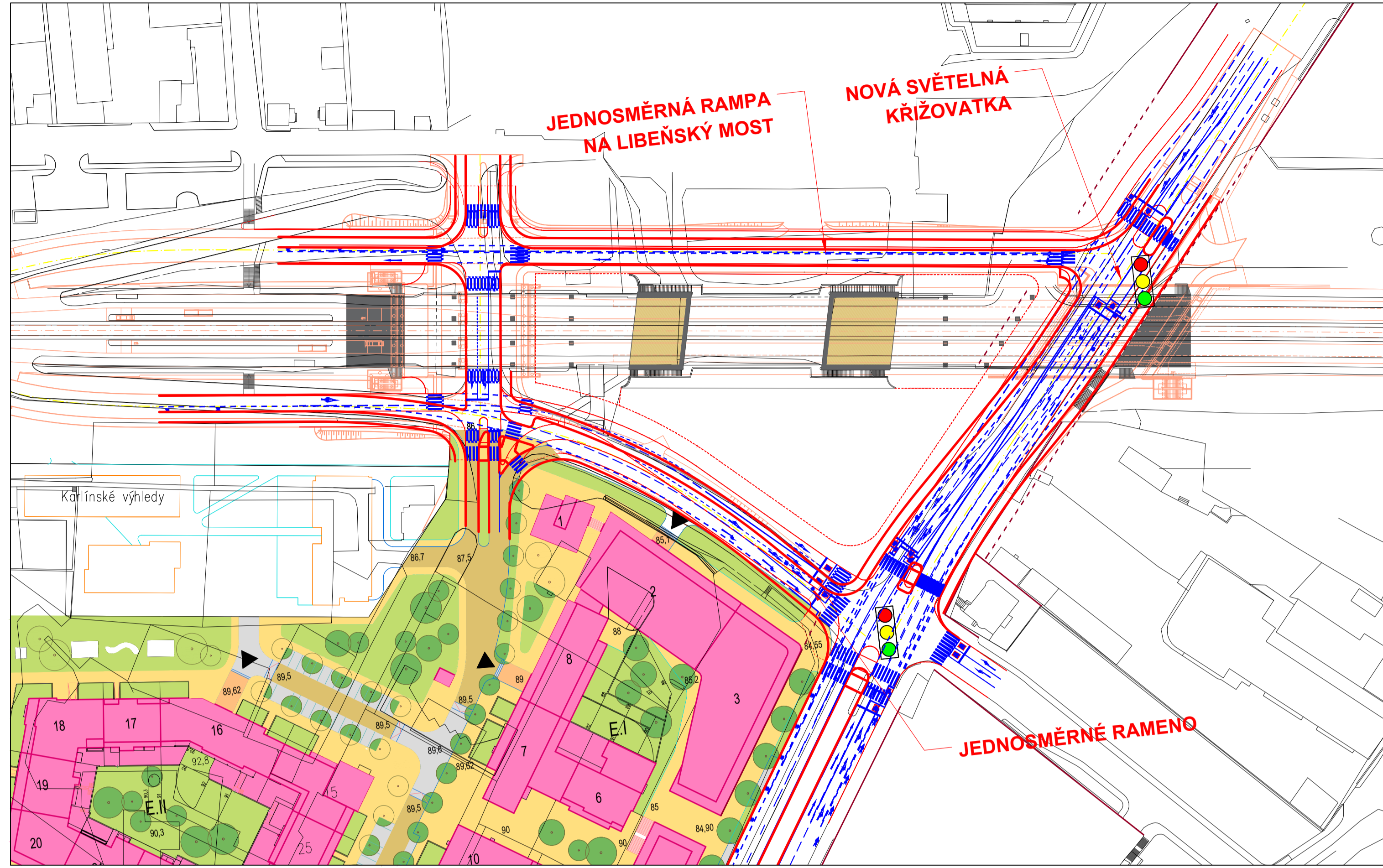

OVERLAY: T-A STUDY (2020) + BPD PRAGOPROJEKT (2006)

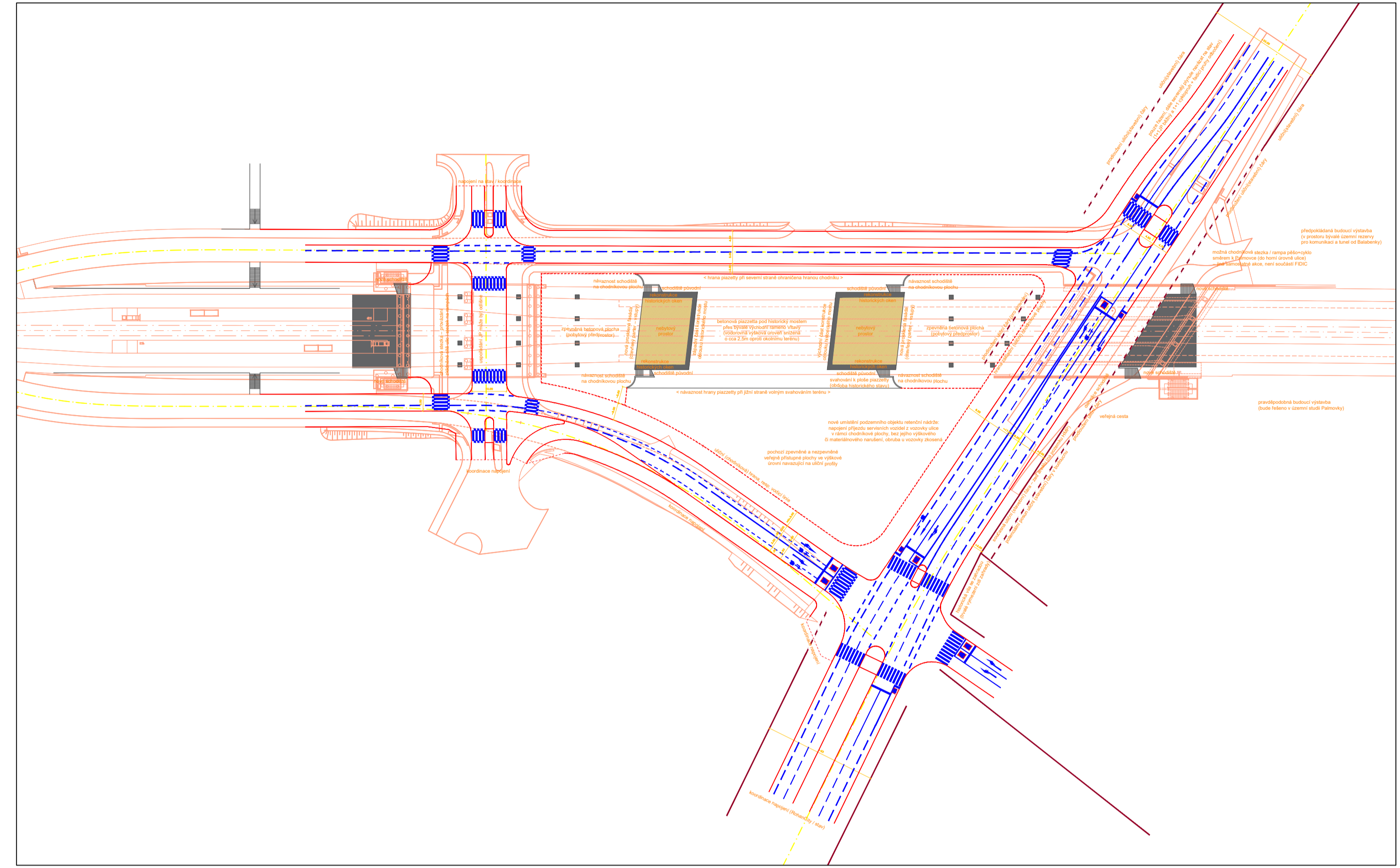

OVERLAY: TRANSPORT-ARCHITECTURAL STUDY (2020) + CURRENT STATE (2020)

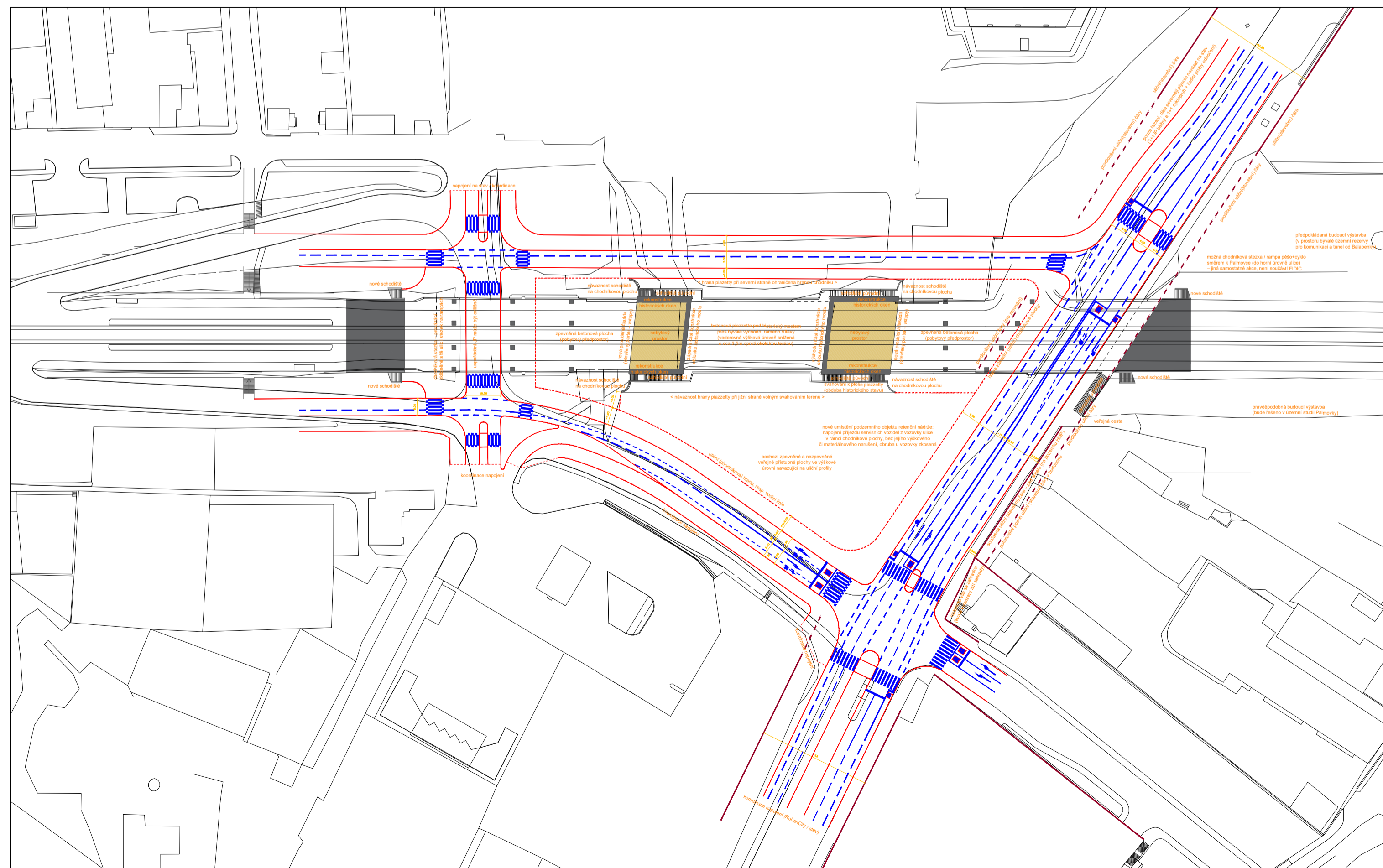

TRANSPORT-ARCHITECTURAL STUDY (2020)

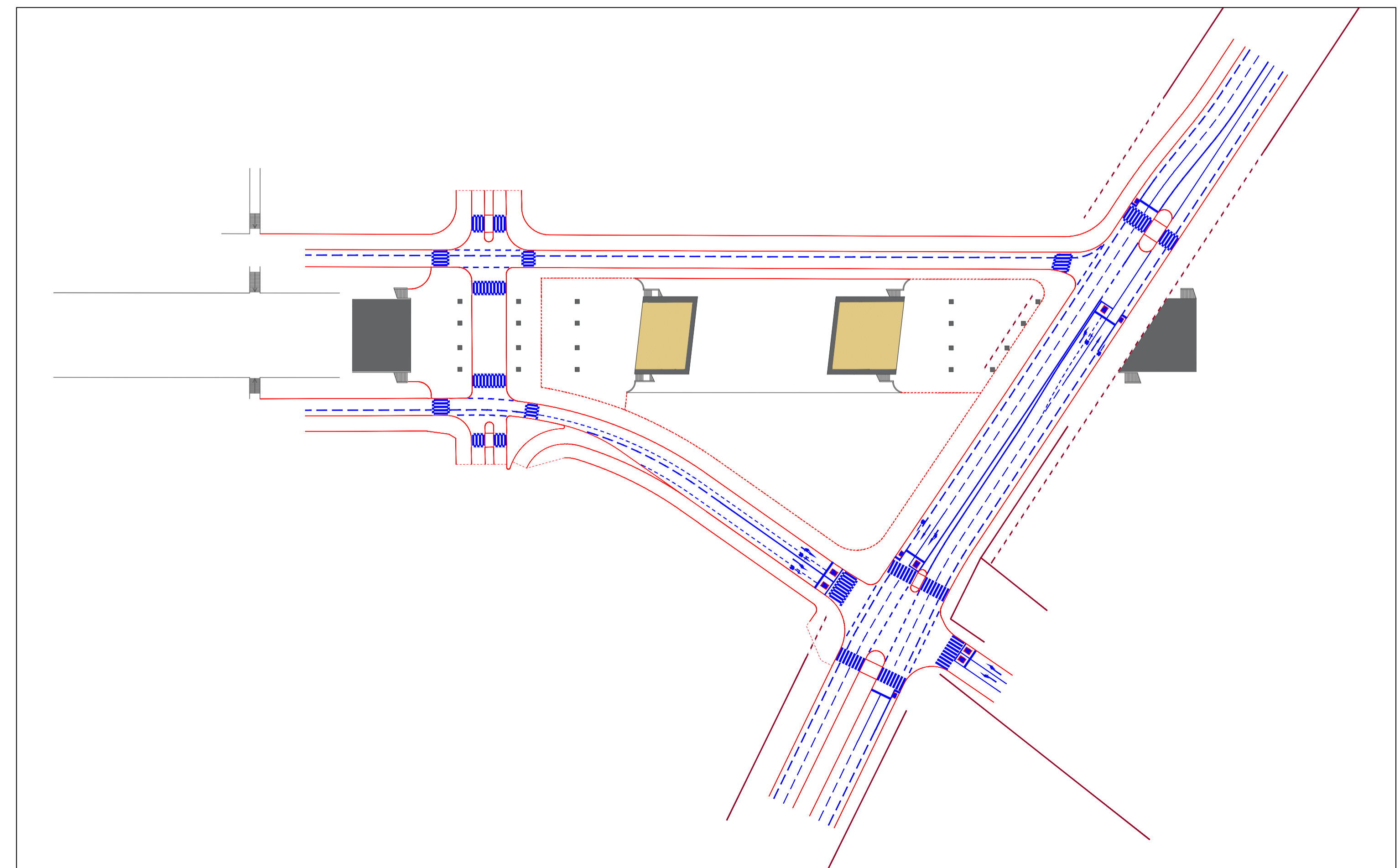

LIBEŇ BRIDGE / CROSS SECTION LAYOUT

WEST AREA OF THE ADJOINT BRIDGES (BRIDGE OVER VLTAVA + FLOOD BRIDGE)

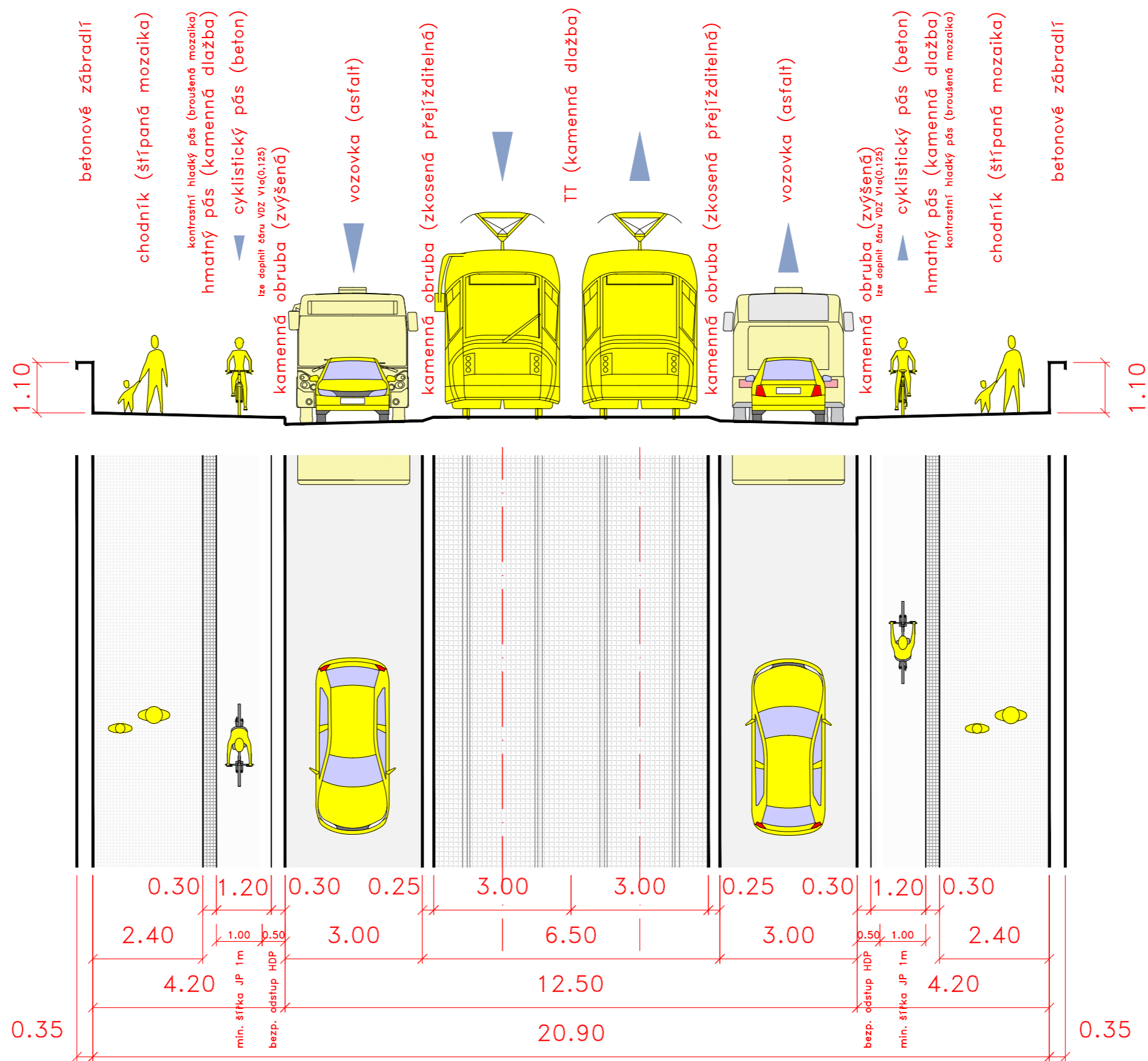

LIBEŇ BRIDGE / CROSS SECTION LAYOUT TRAM STOP

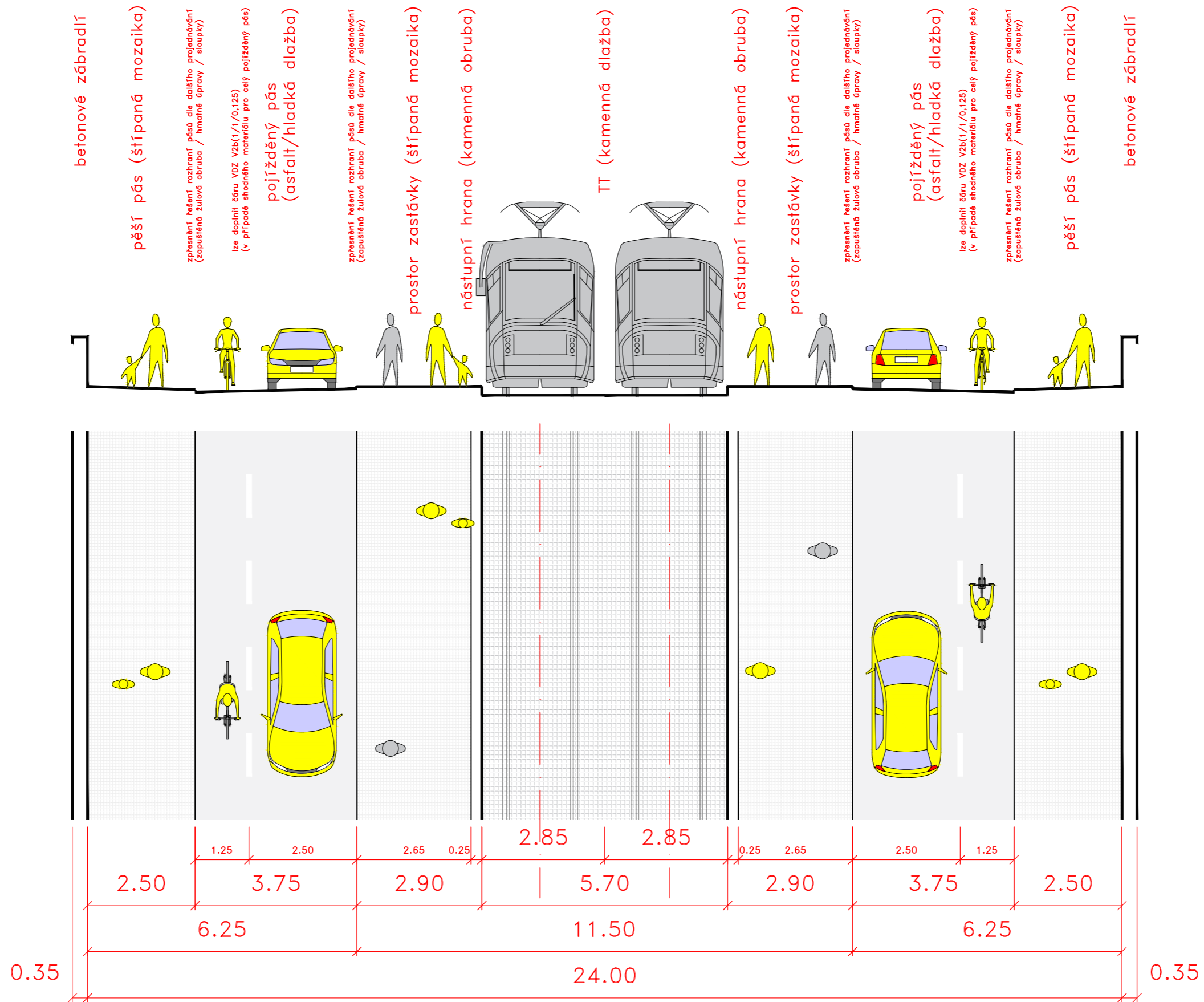

LIBEŇ BRIDGE / CROSS SECTION LAYOUT

EAST AREA OF THE ADJOIT BRIDGES (ŠTORCHOVA–VOC TÁŘOVA+ARCH BRIDGE)

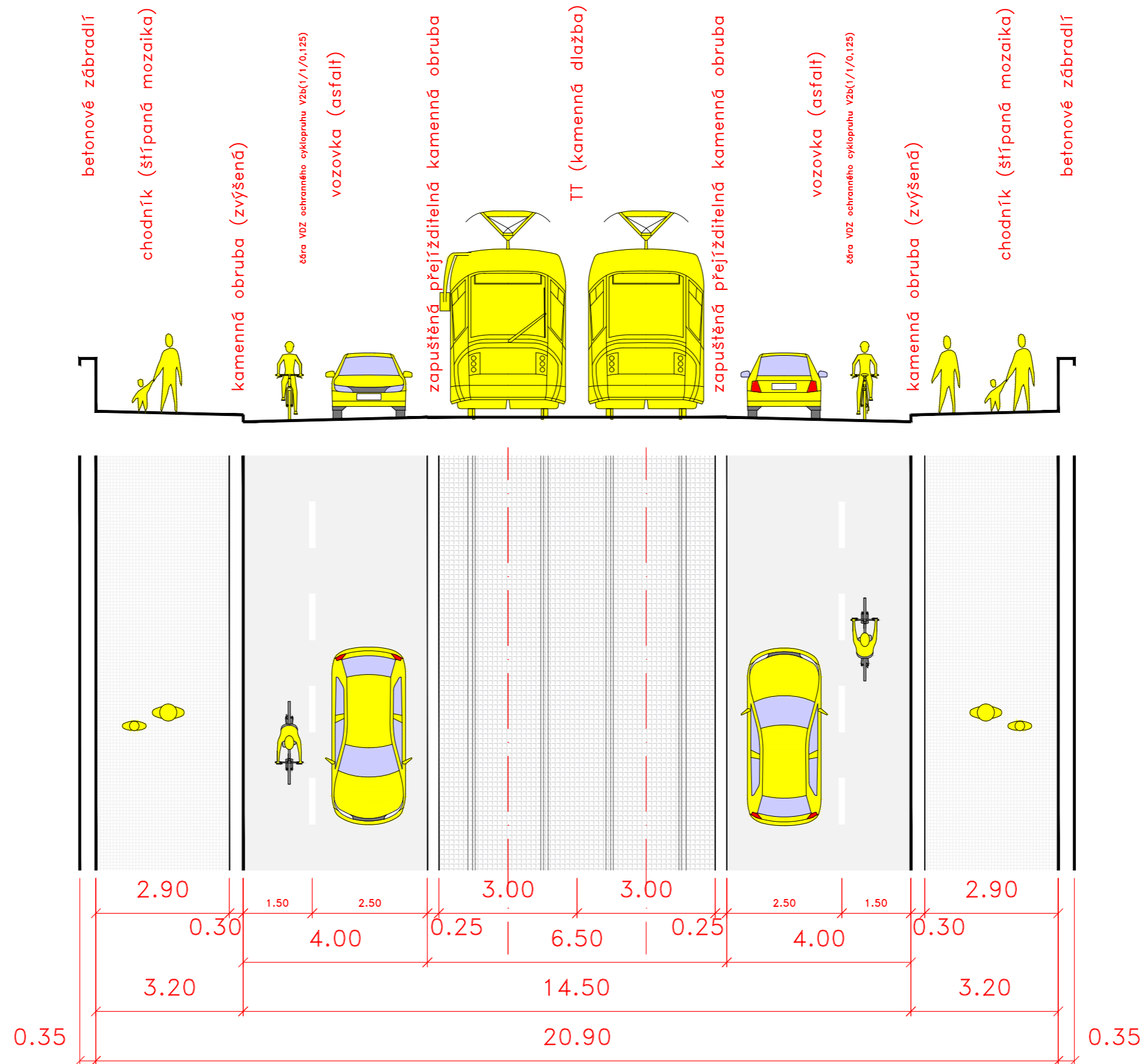

LIBEŇ BRIDGE / CROSS SECTION LAYOUT TERRAIN SECTION (EAST FROM VOC TÁŘOVA)

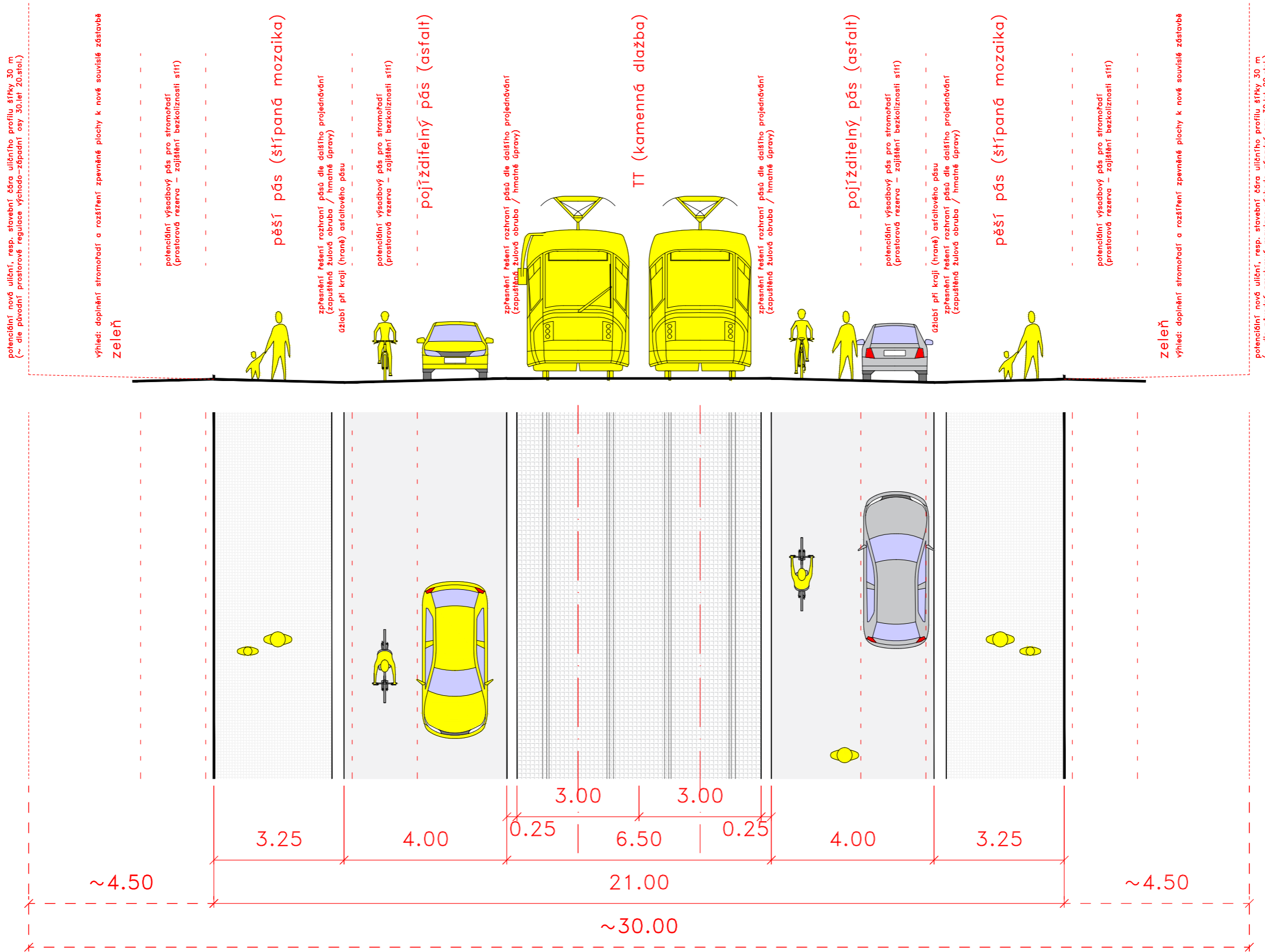

LIBEŇ BRIDGE / RAMP CROSS SECTION LAYOUT

RAMP-SOUTH

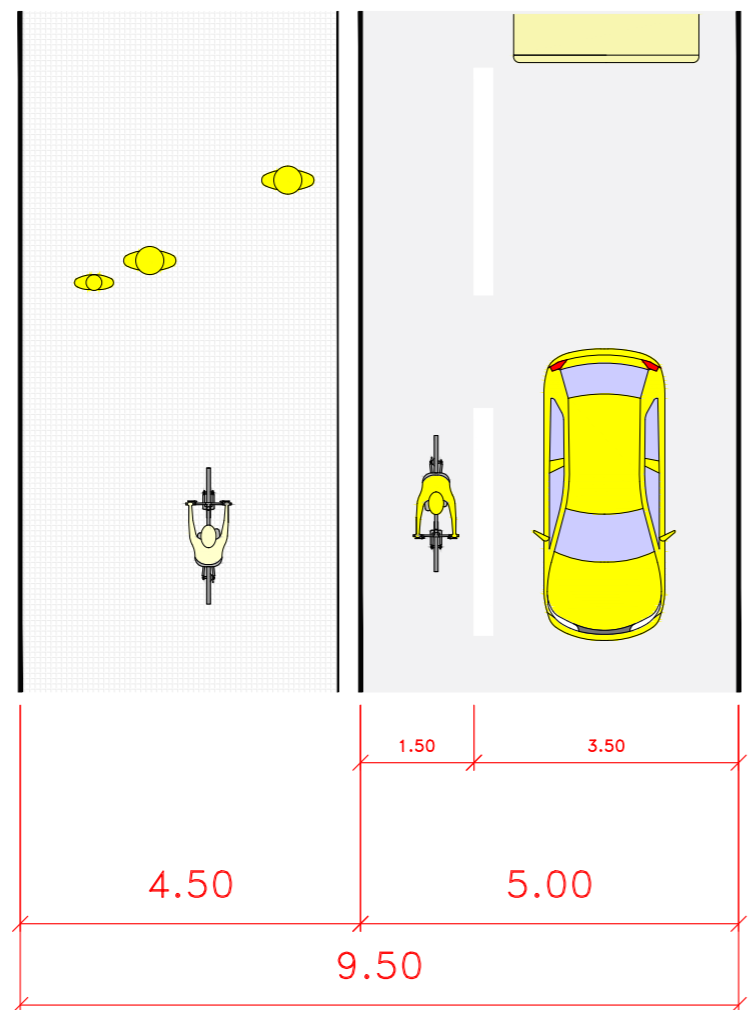
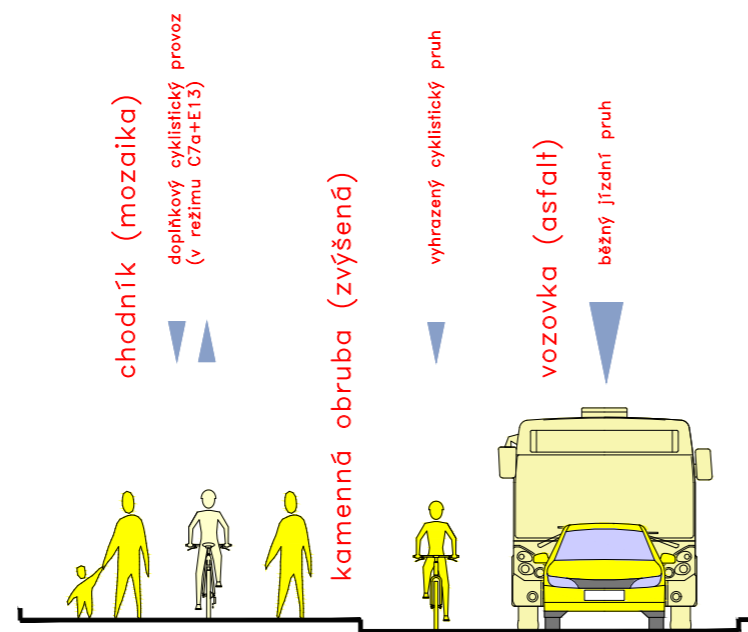

RAMP-NORTH

